

USER'S GUIDE

Tanginox/Radianox Extractor

Ref. 539-5310-10253
10351-10357-10371



*Non-contractual
pictures*



THOMAS APICULTURE

French designer and manufacturer
Of beekeeping equipment

ZA de l'Évangile
321, rue Bernard de la Rochefoucauld
45450 Fay-aux-Loges – France
Tél: +33 (0)2 38 46 88 00
Fax : +33 (0)2 38 59 28 28
E-mail : contact@thomas-apiculture.com

The Radianox (radial) and the Tanginox (tangential) extractors can extract any type of honey from any type of frame for beekeepers who have up to 50 hives.

The machine is manual or electric. The manual model can easily be electrified using the Adapt'matic lid (ref. 8026).

Technical Definition

Stainless-steel

Capacity:

Ref. 539/5310 : 9 ½ Dadant ou Voirnot
13,5 cm frames

Ref. 10357/10371 : any 4 ½ or 4
Langstroth frames

Ref. 10253/10351 : 6 ½ frames or 3 big
Langstroth, Dadant, Voirnot frames

Diameter : 530 mm

Height : 630 mm

Geared motor (electrified versions)
single phase 220 V – 110 W

SAFETY PRECAUTIONS

ATTENTION : (electric models) Before connecting the appliance to a power supply, make sure that your electric installations comply with current standards (differential circuit breaker protection, earth wire, etc.).

Check the supply voltage.

Before using the unit for the first time, clean it to remove any residual metal shavings or filings.

Keep out of the reach of children - Unplug after each use.

When using the machine on stands (1), make sure that it is secured to the ground (the machine is delivered with drilled stands for this purpose).

Make sure that the extractor cage is as well balanced as possible when loading the frames: always maintain symmetry according to the central axis.

Do not open the lid (2) when the appliance is running.



Non-contractual documentation.

The characteristics stated are given without engagement on our part and can be modified without notice.

- Version du 18/06/2020 -



Non-contractual documentation.
The characteristics stated are given without engagement on our part and can be modified without notice.

- Version du 18/06/2020 -

OPERATING PRINCIPLE

The Radianox and Tanginox extractors enable you to extract quickly and easily honey from frames.

The honey is led by the sloped bottom to a stainless steel sleeve with a flap valve (3).

Each model has a ½ transparent lid (2) to monitor the progress of the extraction process.

The radial cage of the extractor is composed of 2 ½ crowns adjustable in height, in order to be able to extract all types of frames.

Options :

- The Radianox can receive 3 tangential stainless steel (ref. 3350) or chromed (ref. 11102) grids to extract viscous honey. Each unit is also available in an electric version, by simply adding a ½ lid with motor (ref. 8026).
- Each appliance can be equipped with lid dryer baskets (Ref. 3406) to recover the honey from the lids.



Radial Cage



Tangential cage

ASSEMBLY

▪ Stands assembly

Slightly tilt the unit. Insert the foot into the slot.
Tighten the knob. Repeat for the other two feet.

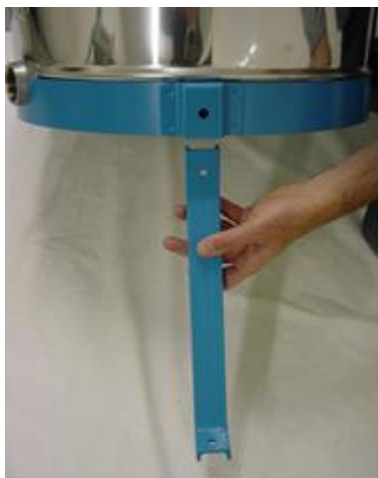

Insert the stand into the slot...



...and tighten the knob.

▪ Installing the handle protections

Twist the cover to soften the plastic.
Place the cover on the top of the handle.
Push down to insert the lower part.



Twist the cover...

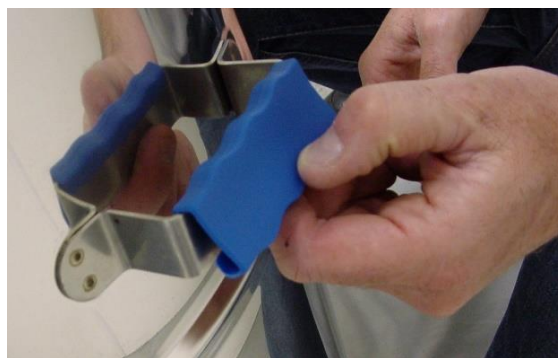

...and place it on the handle

- Setup

Twist the cover to soften the plastic.

Place the cover on the top of the handle.

Push down to insert the lower part.

- Handle setup (Refs. 539/10253/10357)

CAUTION: Once assembled, the crank handle will not be removable.

This unit is delivered with the crank handle removed.

Simply put it in place as shown in the illustration below, and engage the washer using a hammer. Do not forget to insert the spring between the crank handle and the handle.

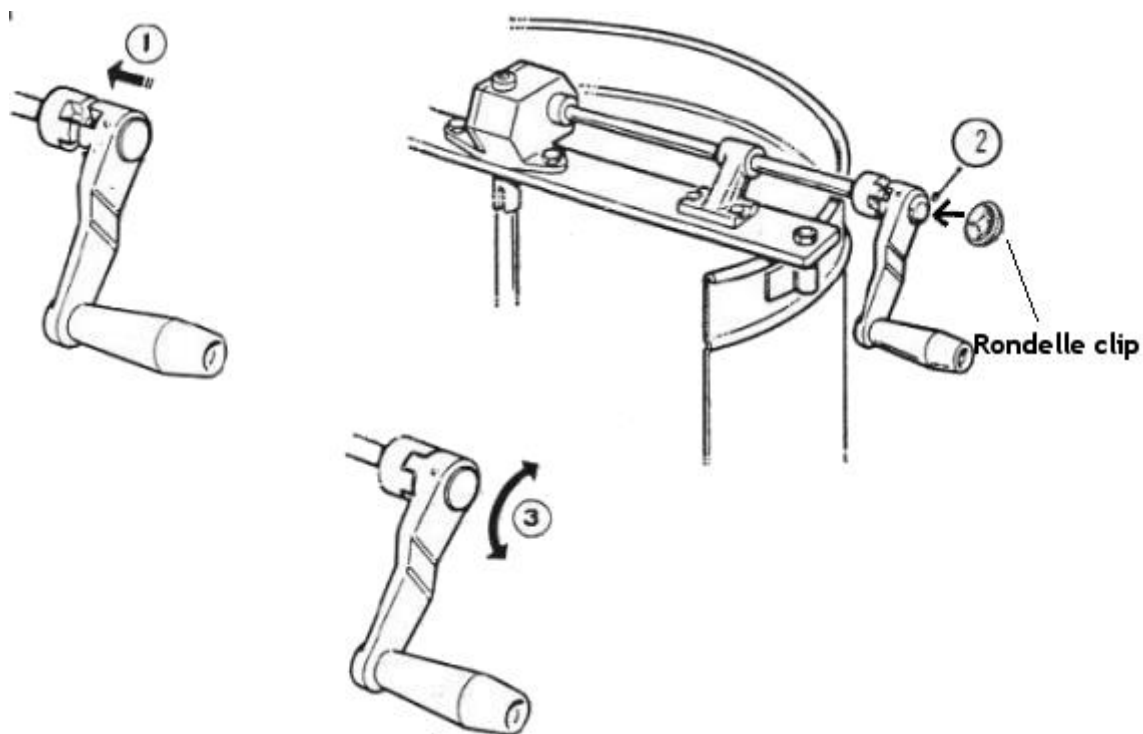

USAGE GUIDE

- Manual Versions (Refs. 539/10253/10357)

Extraction :

Open the transparent lid.

Place the uncapped frames vertically in the cage, taking care to balance the load, and putting the heels outwards.

Close the lid.

Start the extraction by turning the crank at low speed and accelerate as the frames are emptied and lighten.

Wait for the cage to stop completely.

Collect the extracted frames.

Important: Extraction must be carried out with the tap open to prevent honey from accumulating in the extractor. The honey is collected in a container under the tap.

- Electric versions (Refs. 5310/10351/10371)

Extraction :

Connect to the electrical supply.

Open the transparent lid.

Place the uncapped frames vertically in the cage, taking care to balance the load, and putting the heels outwards.

Close the lid. The "click" of the safety device must be audible when closing (and opening) the lid.

Press the ON/OFF switch (8).

Turn the speed variator in slow gear (medium for tangential extraction) in the chosen direction et wait a couple minutes before raising the speed.

Once the extraction is completed, put the lever (9) back to 0 and wait for the complete stop of the cage.

Press the ON/OFF switch to stop the machine.

Collect the extracted frames

NOTE: Opening the lid during the cycle stops the motor.

CAUTION : The extraction must always be done with the tap open, to avoid honey accumulation at within the tank. The honey should flow into a container placed underneath the outlet.



Non-contractual documentation.

The characteristics stated are given without engagement on our part and can be modified without notice.

- Version du 18/06/2020 -



Speed lever (8)



ON/OFF switch(7)



Lid safety device (9)

MAINTENANCE

WARNING: For the electric version, unplug the machine before any maintenance.

Be sure to protect the electrical parts of the machine when cleaning.
Clean with hot water, dry thoroughly by running the empty machine.

The Radianox is a seasonal equipment but must be operated regularly throughout the year, at least a few minutes per month (electric version only).
Store preferably in a dry room with the tap open.

It is necessary to regularly retighten the fixing nuts of the two radial crowns to ensure that the lower crown is not in contact with the bottom of the cage.

The centre plate, located at the base of the rotating axis, may wear out over time: it may then be useful to change it.



Non-contractual documentation.

The characteristics stated are given without engagement on our part and can be modified without notice.

- Version du 18/06/2020 -

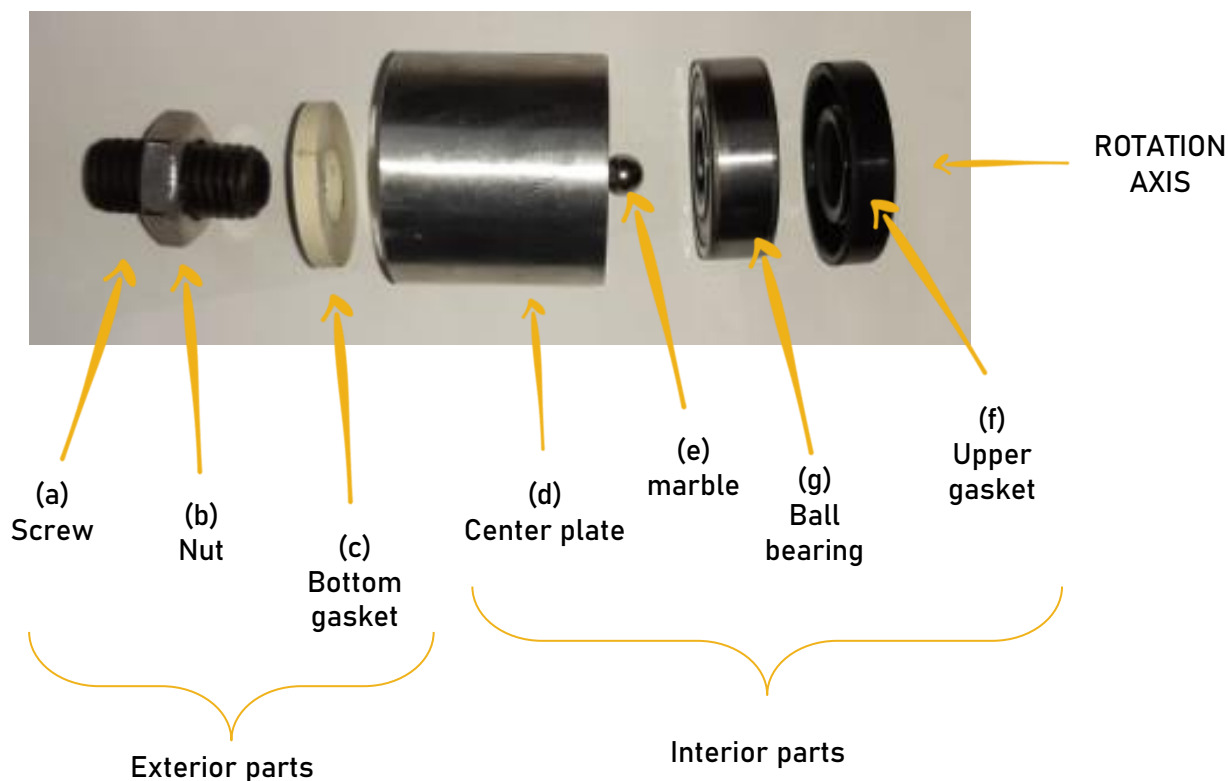

Centre plate assembly:

To change the centre plate, loosen the three nuts on the motor lid. Lift the engine-lid-axle assembly. Unscrew the nut (b) under the extractor.

Replace the damaged parts and reassemble the whole unit. Make sure you do not forget the ball (e) and to grease it with Vaseline or food grade grease.

Be careful to tighten the screw (a) in the right position with a hexagonal wrench.

Frequent questions

CAUTION : Unplug the machine before any work is carried out.

Problem	Possible solution
The unit does not start (electric version)	<ul style="list-style-type: none"> - Check that the unit is connected to the electrical supply. - Check the power supply (power failure). - Check that the controller (7) is not set to 0. - Check that the transparent lid (2) is properly closed and that the safety contact (8) is correctly engaged ("click" when opening and closing). -If this is not the case, twist the plate slightly outwards.
The motor or handle does not engage the cage	<ul style="list-style-type: none"> - Check the centre plate: the cage axle must be engaged in the one coming out of the motor or handle. -If it is not the case: tighten the bolt underneath the extractor.
The extractor is having trouble running	<ul style="list-style-type: none"> - Check that there still is a marble inside the centre plate - Replace the centre plate if it is worn out. (see p.8)



If the problems are still there,
please contact us :

Technical Help:

High season 12H/24 and 6 days /7
(Monday - Saturday 8:00 am - 8:00 pm)

Off season 8H/24 et 5 days /7
(Monday - Friday from 8:00 to 12:00
And from 1:30 pm to 6:00 pm)

assistance-technique@thomas-apiculture.com

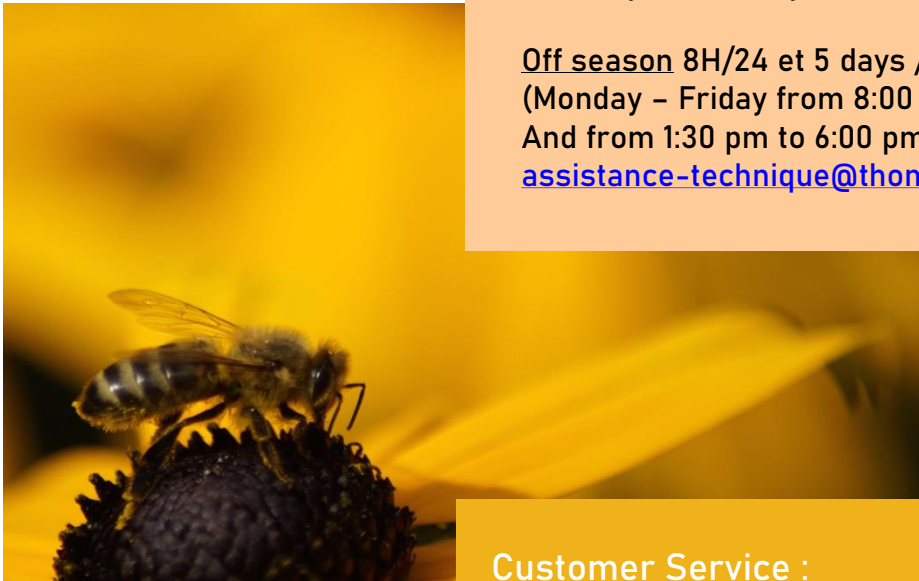

Customer Service :

02 38 46 88 00

From 8:00 am to 12:00 am

And from 2:00 pm to 5:30 pm

From Monday to Friday

contact@thomas-apiculture.com